

Desktop Robot SD500

SD Series robots are compact, small and lightweight, ideal for material handling, picking up and sorting, and assembly applications with fast speed and high accuracy. With build-in cables, SD Series robots can fit in narrow working space and can be floor mounted, inverted or wall mounted at any angle. Robot SD500 has 3kg rated wrist payload, 5kg maximum wrist payload and 500mm maximum working radius.

Features

1. Lightweight
2. High running speed
3. High position repeats accuracy
4. Build-in cable

Application

Material Handling

1. More flexible, more stable, less energy consumption
2. High performance of moving stuff
3. Exceptionally long run time
4. Save floor space
5. Larger working area

Assembling

1. High speed and high repeat positional accuracy
2. Save floor space
3. Exceptionally long run time

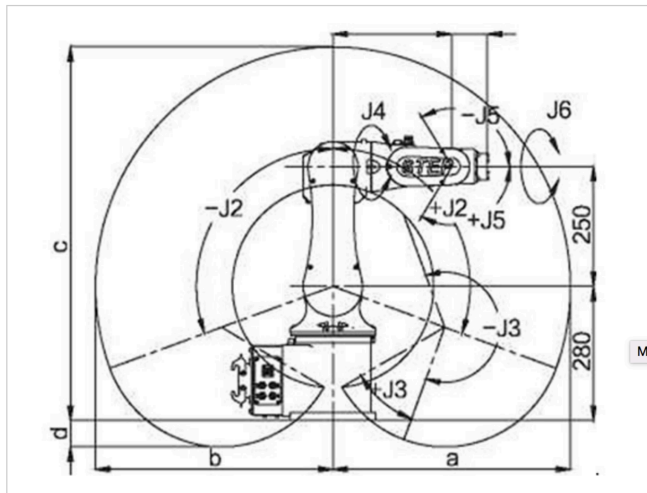

Material Handling

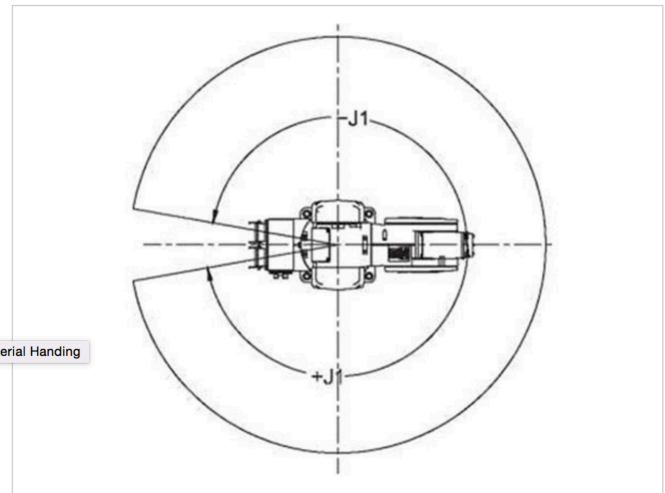

Model		SD500
Wrist Payload		Rated 3kg
		Maximum 5kg
Max Working Radius		500 mm
DOF		6
Max Speed	J1	370°/s
	J2	370°/s
	J3	430°/s
	J4	300°/s
	J5	460°/s
	J6	600°/s
Max Operation Area	J1	±170°
	J2	±110°
	J3	+40°~220。
	J4	±185°
	J5	±125°
	J6	±360°
Max Moment Allowable Torque	J5	35 Nm
	J6	24 Nm
Weight		28 kg
Position Repeat Accuracy		± 0.02mm
Working Temperature		0 ~40°C